

NOTE: Proposed addition fits within all property lines and setbacks stipulated by Hemisfair Area Development Corporation

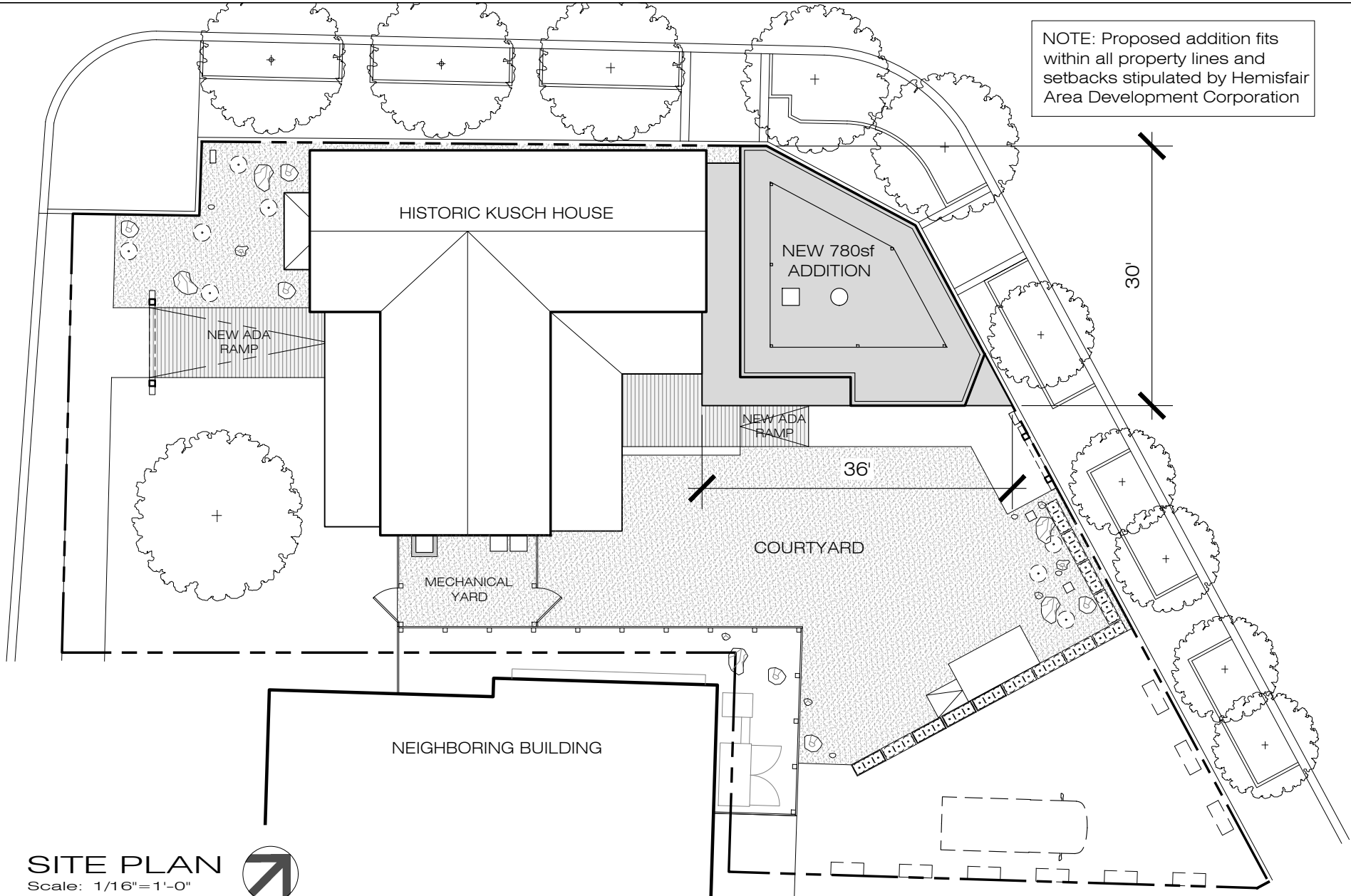

SITE PLAN
Scale: 1/16"=1'-0" 

Project:

Kusch House
600 Hemisfair Plaza way
San Antonio, TX 78205

Sheet:

Candid Works Architecture PLLC
215-1 Groveton Street
San Antonio, TX 78210
Office: 210.444.1051
candid@candid-works.com
©Candid Works Architecture 2022

4