

PRODUCT OVERVIEW



Double-Hung Windows

Choose Woodwright® double-hung windows that replicate the look of traditional architecture or our best-selling tilt-wash double-hung windows that are extremely energy efficient. Both are available as full-frame or insert windows, and can be part of bay window combinations. Coordinating picture and transom windows are also available.



Specialty Windows

A collection of stylish shapes to help distinguish a home's style or create a delicate accent.



Woodwright full-frame windows come in a variety of shapes.



Our **Narroline® double-hung window conversion kit** can upgrade Andersen® Narroline double-hung windows to tilt-wash windows.



Complementary specialty windows offer 35 additional shapes and custom sizes.



Casement & Awning Windows

Casement and awning windows are energy efficient, and are built with our low-maintenance Perma-Shield® cladding. Available for new construction or replacement, as integral twin or triple units, or as part of bay or bow window combinations. Coordinating picture and transom windows are also available.



Gliding Windows

Superior energy efficiency, reliable performance and uncommon beauty. Both sash on our gliding windows open for improved ventilation.

Complementary casement windows come in a variety of shapes and in French casement options.



Frenchwood® Gliding & Hinged Inswing Patio Doors

Wide wood profiles provide the authentic craftsmanship of traditional French doors, and our Perma-Shield exterior cladding protects the unit and offers low maintenance. Add blinds-between-the-glass to conveniently control light and privacy. To learn more about other traditional- and contemporary-style Andersen door options, visit andersenwindows.com/doors.

Frame any Frenchwood patio door with **Frenchwood patio door sidelights and transoms**.



Complementary curved top patio doors, including Springline™ and arch hinged doors, are handcrafted and complement our 400 Series products.

WOODWRIGHT® DOUBLE-HUNG INSERT WINDOWS

FEATURES

FRAME

A A Fibrex® material exterior protects the frame – beautifully. Best of all, it's low maintenance and never needs painting.*

B For exceptional long-lasting† performance, sill members are constructed with a wood core and a Fibrex material exterior.

C Natural wood stops are available in pine, maple, oak and prefinished white. Wood jamb liners add beauty and authenticity to the window interior.

D Multiple weatherstrip systems help provide a barrier against wind, rain and dust. The combination of spring-tension vinyl, rigid vinyl and flexible bulb weatherstrip is efficient and effective.

E Exterior stop covers are specially designed to allow easy application of high-quality sealant.

3 1/4" (83) "pocket window" jamb depth allows convenient replacement without disturbing interior window trim for most double-hung replacement situations.

F For units with white exterior color, the exterior jamb liner is white. For all other units, the exterior jamb liner is gray.

SASH

G Balancers in the sash enable contractors to screw through the jamb during installation without interfering with the window's operation.

Wood Jamb Liner



H Natural wood sash interior with classic chamfer detailing. Available in pine, maple, oak or prefinished white.

I Low-maintenance sash exterior provides long-lasting† protection and performance. Sash exteriors on most units include Fibrex material.

J Sash joints simulate the look of traditional mortise-and-tenon construction inside and out.

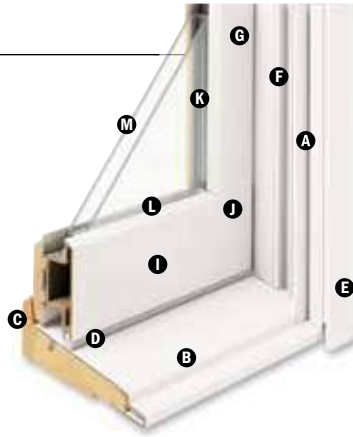

GLASS

K In addition to stainless steel glass spacers, black or white glass spacers are now available to allow the spacer to blend in with the unit color.

L Silicone bed glazing provides superior weathertightness and durability.

M High-Performance options include:

- Low-E4® glass
- Low-E4 HeatLock® glass
- Low-E4 SmartSun™ glass
- Low-E4 SmartSun HeatLock glass
- Low-E4 Sun glass

Tempered and other glass options are available. Contact your Andersen supplier.

A removable translucent film helps shield the glass from damage during delivery and construction, and simplifies finishing at the job site.

Patterned Glass

Patterned glass options are available. See page 12 for more details.

HARDWARE



Standard lock and keeper design provides an easy tilt-to-clean feature integrated into the lock.

SILL ANGLES

Three sill angles are available – 0°, 8° and 14° – to closely match the existing sill in window replacement applications. See page 71 for details.



0° Sill Angle



8° Sill Angle



14° Sill Angle

Sill Angle Finder App

Our Sill Angle Finder App lets you quickly and easily find the sill angle of existing double-hung windows. Available for free for both iPhone® and Android™ smartphones. Download the app for iPhone from the App Store™ or for Android smartphones from the Google Play Store. The app is only available for smartphones, as tablets and other large devices are too bulky for measuring window sill angles.

INSTALLATION

Exterior Stop Cover



An exterior stop cover provides a clean transition from the new window to the existing window casing.

Included Installation Materials



Flat self-hanging shims, backer rod, installation screws and complete instructions are included with each insert window. See the measurement guide and worksheet at andersenwindows.com/measure.

SASH OPTIONS**



Cottage

Reverse Cottage

*Visit andersenwindows.com/warranty for details.

**Shown on 400 Series tilt-wash double-hung full-frame windows.

"iPhone" and "App Store" are registered trademarks of Apple Inc. "Android" is a trademark of Google Inc.

Dimensions in parentheses are in millimeters.

Grille Patterns

	Diamond*	Prairie A	6-Light Prairie	Colonial						
Tilt-Wash Double-Hung										
Tilt-Wash Picture										
Tilt-Wash Transom										

Patterns for double-hung windows are also available in Upper Sash Only (USO) configurations. For picture window patterns that require alignment with double-hung window patterns, identify the sash style (equal, cottage or reverse cottage) when ordering. **Number of lights and overall pattern varies with window size. Patterns not available in all configurations.**

*Available only in Simulated Divided Light (SDL) configuration and only in 3/4" (19) and 7/8" (22) widths.

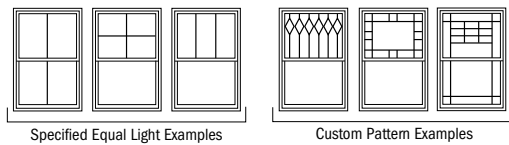

Specified equal light and custom patterns are also available. For more grille options, see page 14 or visit andersenwindows.com/grilles.

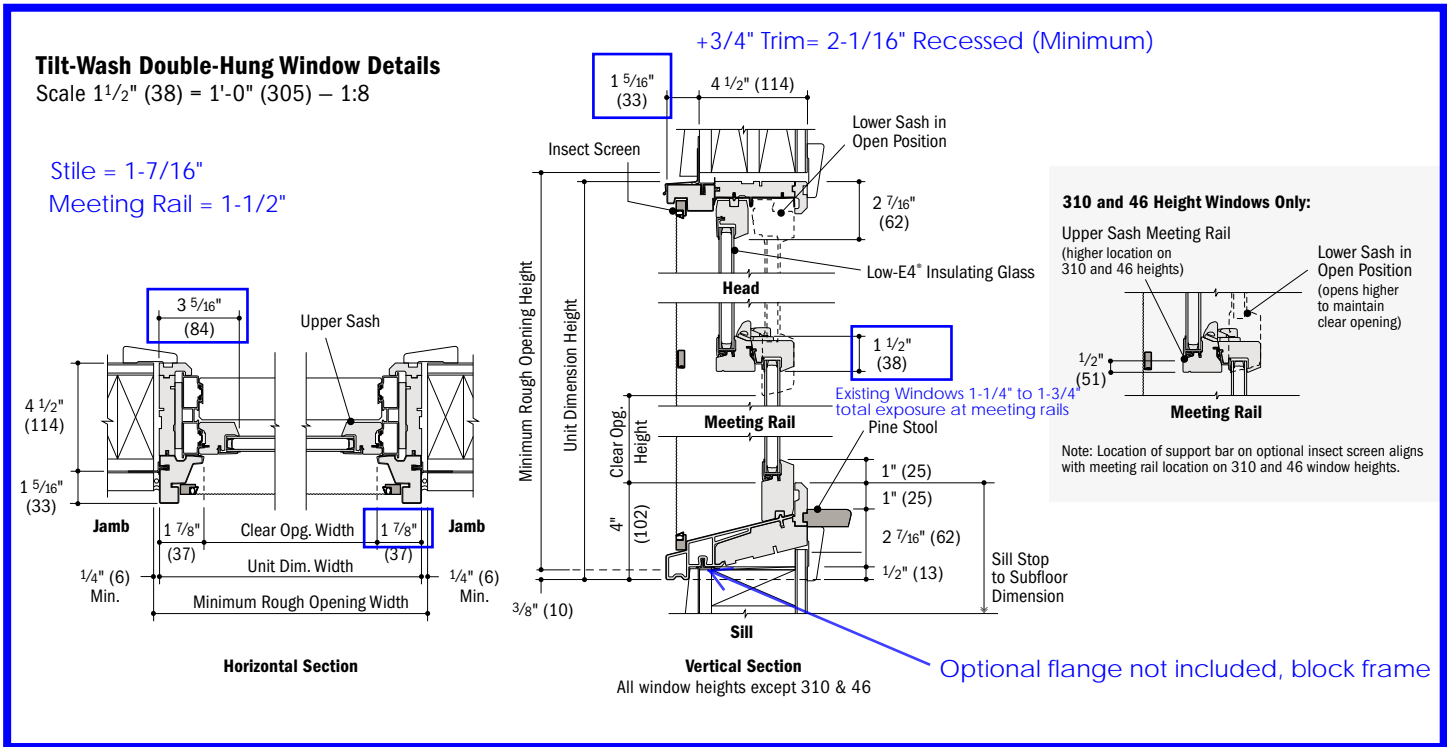

400 Series Tilt-Wash Double-Hung Full-Frame Windows

- Light-colored areas are parts included with window. Dark-colored areas are additional Andersen® parts required to complete window assembly as shown.
- **Minimum rough openings may need to be increased to allow for use of building wraps, flashing, sill panning, brackets, fasteners or other items. See installation information on pages 210-211.**
- Details are for illustration only and are not intended to represent product installation methods or materials. Refer to product installation guides at andersenwindows.com.
- Dimensions in parentheses are in millimeters.

TILT-WASH DOUBLE-HUNG FULL-FRAME WINDOWS

Tilt-Wash Picture Window Details

Scale 1 1/2" (38) = 1'-0" (305) – 1:8

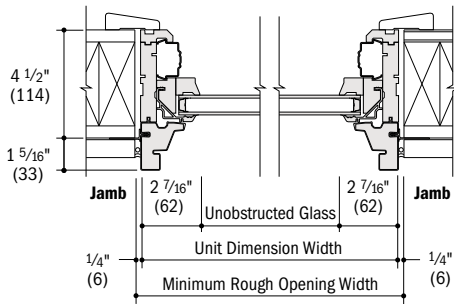

Horizontal Section

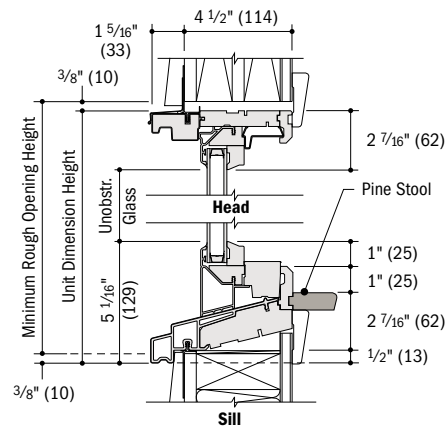

Vertical Section

Tilt-Wash Transom Window Details

Scale 1 1/2" (38) = 1'-0" (305) – 1:8

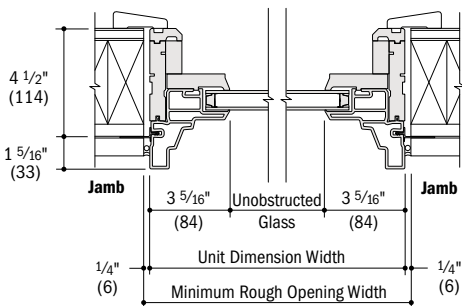

Horizontal Section

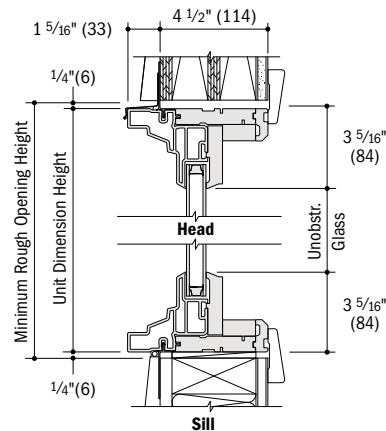

Vertical Section

Horizontal (stack) Joining Detail

Scale 1 1/2" (38) = 1'-0" (305) – 1:8

Overall Window Dimension Height

Sum of individual window heights
plus 1/16" (1.5) for each join.

Overall Rough Opening Height

Overall window dimension height.*

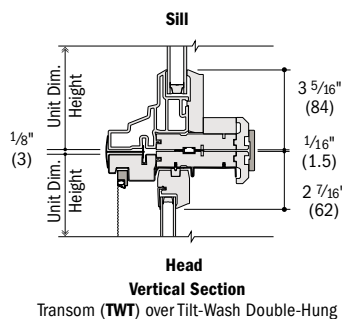

Head
Vertical Section
Transom (TWT) over Tilt-Wash Double-Hung

Vertical (ribbon) Joining Detail

Scale 1 1/2" (38) = 1'-0" (305) – 1:8

Overall Window Dimension Width

Sum of individual window widths
plus 1/16" (1.5) for each join.

Overall Rough Opening Width

Overall window dimension width plus 1/2" (13).

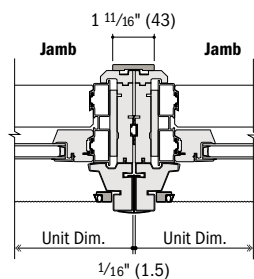

Horizontal Section
Tilt-Wash Double-Hung to Tilt-Wash Double-Hung

For more joining information, see the combination designs section starting on page 181.

Separate Rough Openings Detail

Scale 1 1/2" (38) = 1'-0" (305) – 1:8

To meet structural requirements or to achieve a wider joined appearance, windows may be installed into separate rough openings having vertical support (by others) in combination with Andersen® exterior filler and exterior vinyl trim.

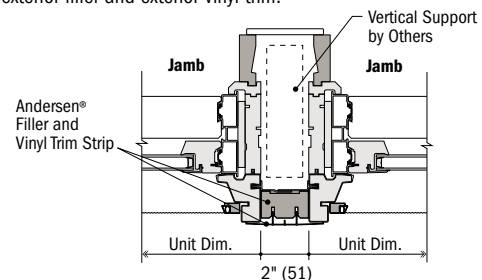

Horizontal Section
Tilt-Wash Double-Hung and Tilt-Wash Double-Hung

* Light-colored areas are parts included with window. Dark-colored areas are additional Andersen® parts required to complete window assembly as shown.

* Minimum rough openings may need to be increased to allow for use of building wraps, flashing, sill panning, brackets, fasteners or other items. See installation information on pages 210-211.

* Details are for illustration only and are not intended to represent product installation methods or materials. Refer to product installation guides at andersenwindows.com.

* Consult with an architect or structural engineer regarding minimum requirements for structural support members between adjacent rough openings.

* Dimensions in parentheses are in millimeters.

* For stacks where bottom unit in combination is a double-hung or picture window with a sloped sill, if bottom window has a flat sill add 1/2" (13) to the overall window dimension height.