

LEGAL DESCRIPTION

PROPERTY ADDRESS 110 W. ELSMERE PL.
SAN ANTONIO, TEXAS 78012

BEING BEING THE WEST 7.5 FEET OF LOT 75
ALL OF LOTS 76, 77, 78 & 79
BLOCK 2 OF NCB 6382 OF MONTA VISTA
IN THE CITY OF SAN ANTONIO
BEXAR COUNTY, TEXAS 78012

TOPOGRAPHY LEGEND

---	EXISTING TOPOGRAPHY
---	PROPOSED TOPOGRAPHY
---	ABANDONED TOPOGRAPHY

PAVING LEGEND

	(P-1) CONCRETE
	(P-2) GRAVEL
	(P-3) BRICK (RE-USE EXISTING BRICK)
	(W-1) STONE WALL (RE-USE EXISTING STONE)

SITE LEGEND

---	ELECTRICAL LINE
---	SEWER LINE
---	WATER LINE
---	PROPERTY LINE
---	CEDAR FENCE
---	WIRE FENCE (TO MATCH EXISTING)

1 Site Plan

Scale: 1/8"=1'-0"

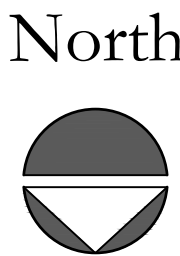

DON B. MCDONALD
ARCHITECTS

Elsmere Studio Addition
110 W. Elsmere Pl.
San Antonio, TX

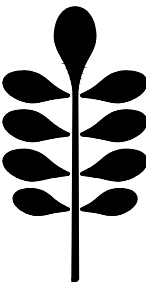

DON B. MCDONALD ARCHITECT
2121 NORTH MAIN AVENUE
SAN ANTONIO, TEXAS 78212
(210) 728-9722

REVISIONS DATE

JOB NO. 25ESA
DRAWN: BB
CHECKED: XXX

A1.1
03/20/2025

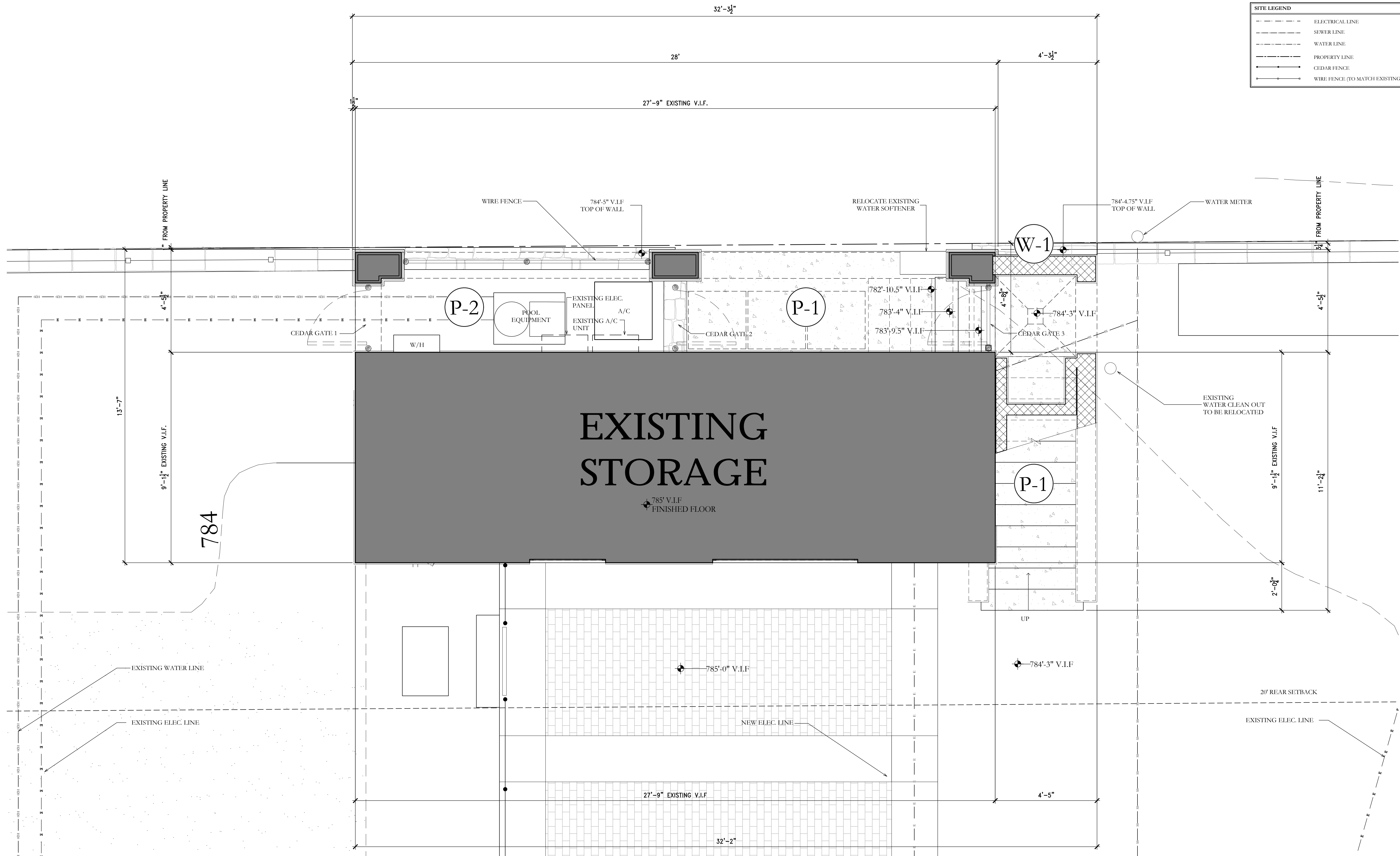

PAVING LEGEND		
	P-1	CONCRETE
	P-2	GRAVEL
	P-3	BRICK (RE-USE EXISTING BRICK)
	W-1	STONE WALL (RE-USE EXISTING STONE)

SITE LEGEND	
	ELECTRICAL LINE
	SEWER LINE
	WATER LINE
	PROPERTY LINE
	CEDAR FENCE
	WIRE FENCE (TO MATCH EXISTING)



DON B. MCDONALD
ARCHITECTS

Elsmere Studio Addition
110 W. Elsmere Pl.
San Antonio TX

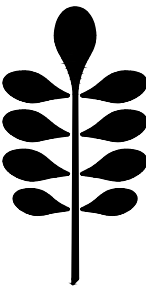

DON B. MCDONALD ARCHITECT
2121 NORTH MAIN AVENUE
SAN ANTONIO, TEXAS 78212
(210) 758-9722

REVISIONS DATE

JOB NO. 25ESA
DRAWN: BB
CHECKED: XXX

A1.2
03/20/2025

1 Enlarged Site Plan

Scale: 1/2"=1'-0"

